

| A | B | C | D | A | B | C | D | | |
|---|---------|------|-----|-----|----|---------|------|-----|-----|
| 1 | KR1-019 | 2029 | 704 | 3/3 | 8 | KR1-316 | 676 | 460 | 2/3 |
| 2 | KR1-017 | 2029 | 704 | 3/3 | 9 | KR1-317 | 676 | 455 | 2/3 |
| 3 | KR1-110 | 2155 | 608 | 1/3 | 10 | KR1-408 | 1368 | 80 | 2/3 |
| 4 | KR1-111 | 2155 | 608 | 1/3 | 11 | KR1-407 | 1368 | 80 | 2/3 |
| 5 | KR1-106 | 2042 | 460 | 1/3 | 12 | KR1-906 | 1634 | 691 | 3/3 |
| 6 | KR1-314 | 1368 | 583 | 2/3 | 13 | KR1-923 | 422 | 691 | 3/3 |
| 7 | KR1-315 | 1368 | 566 | 2/3 | 14 | DR-670 | 670 | | 1/3 |
| | | | | | 15 | | 1367 | 20 | 1/3 |

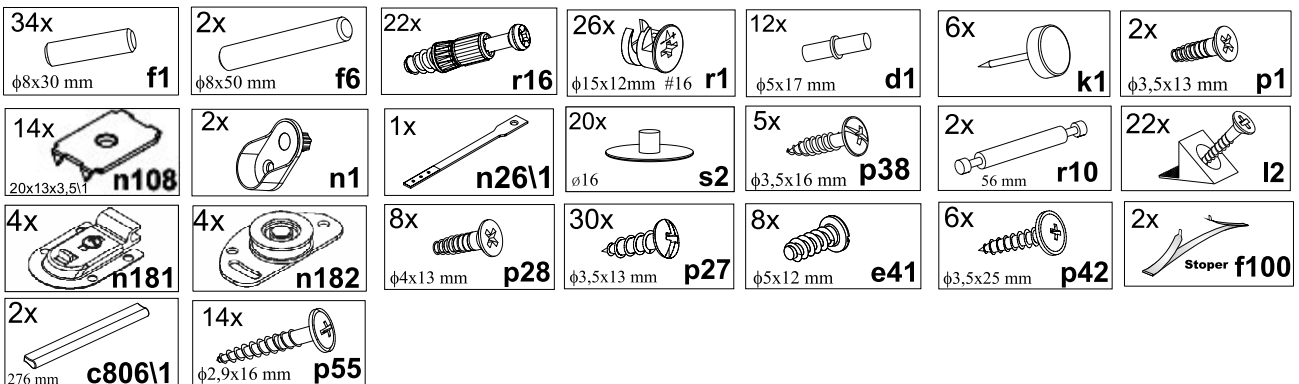

1

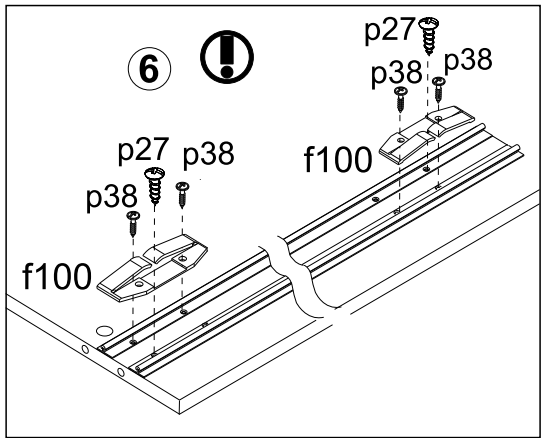
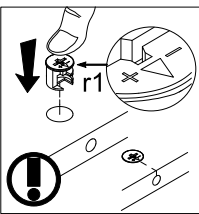
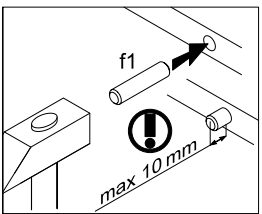
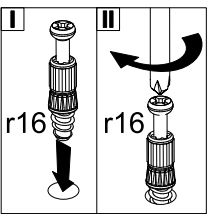
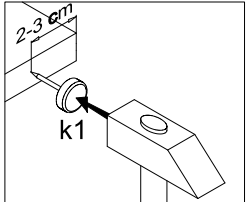
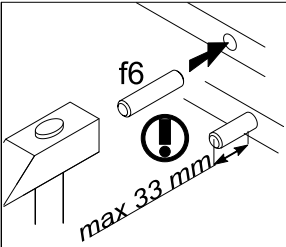
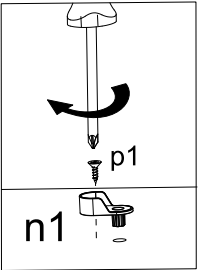
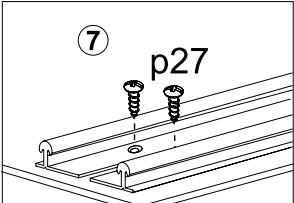
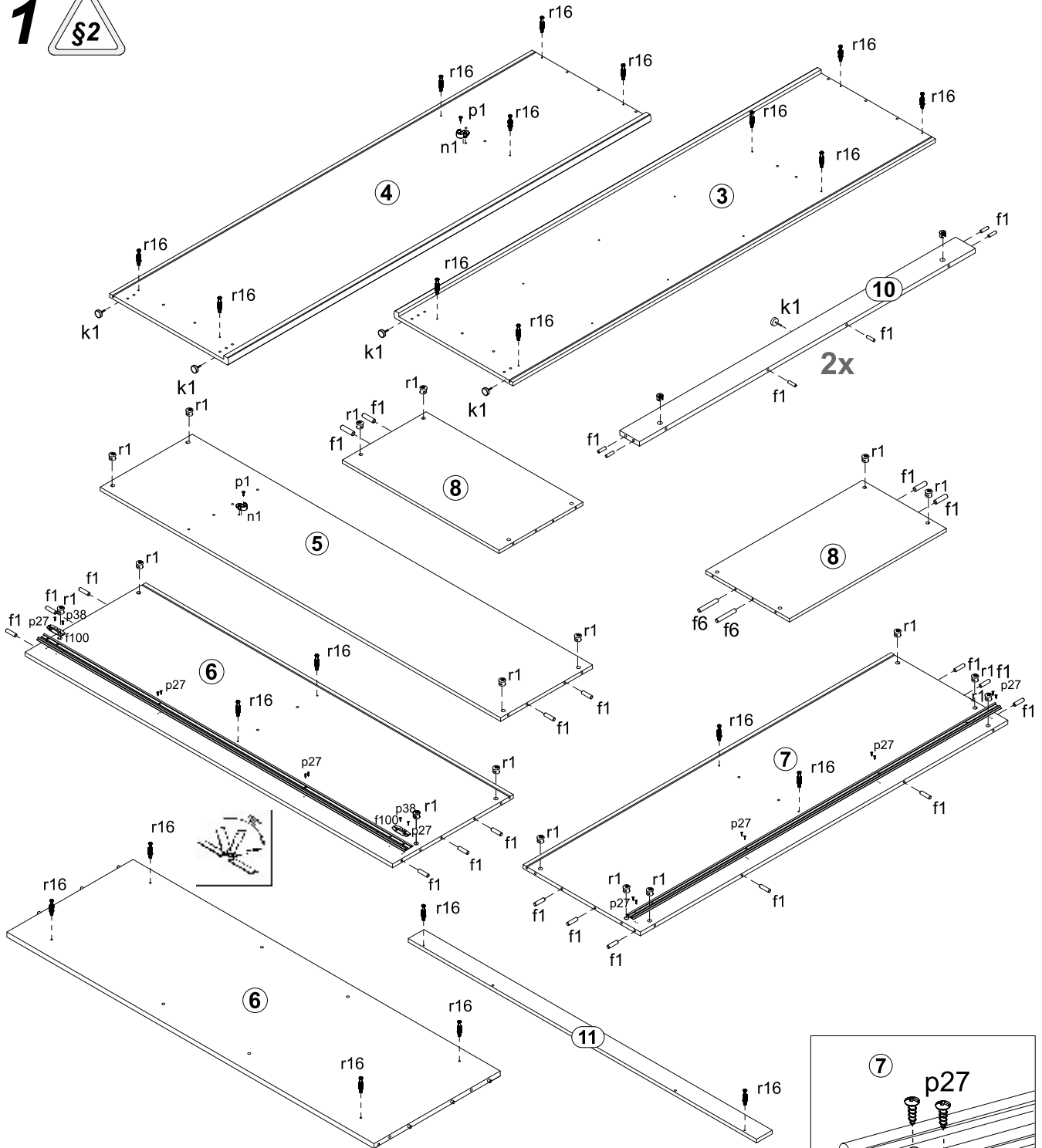

2

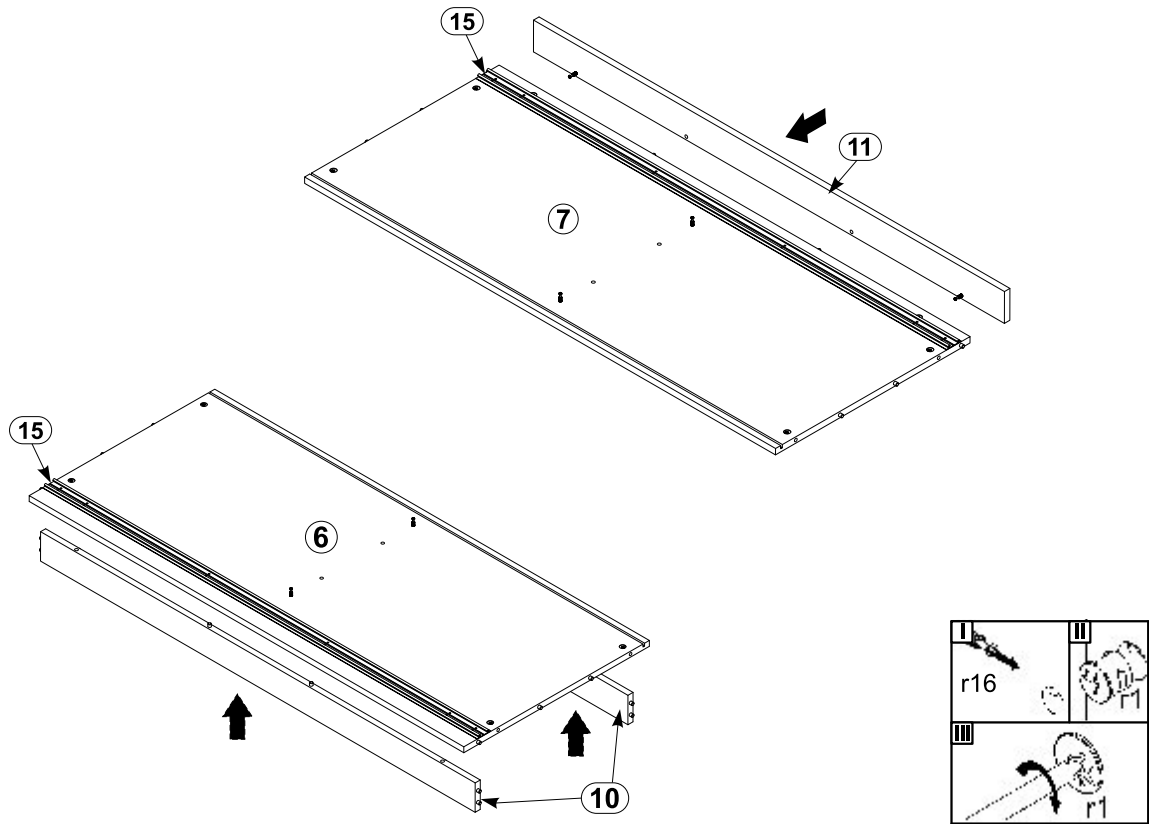

3

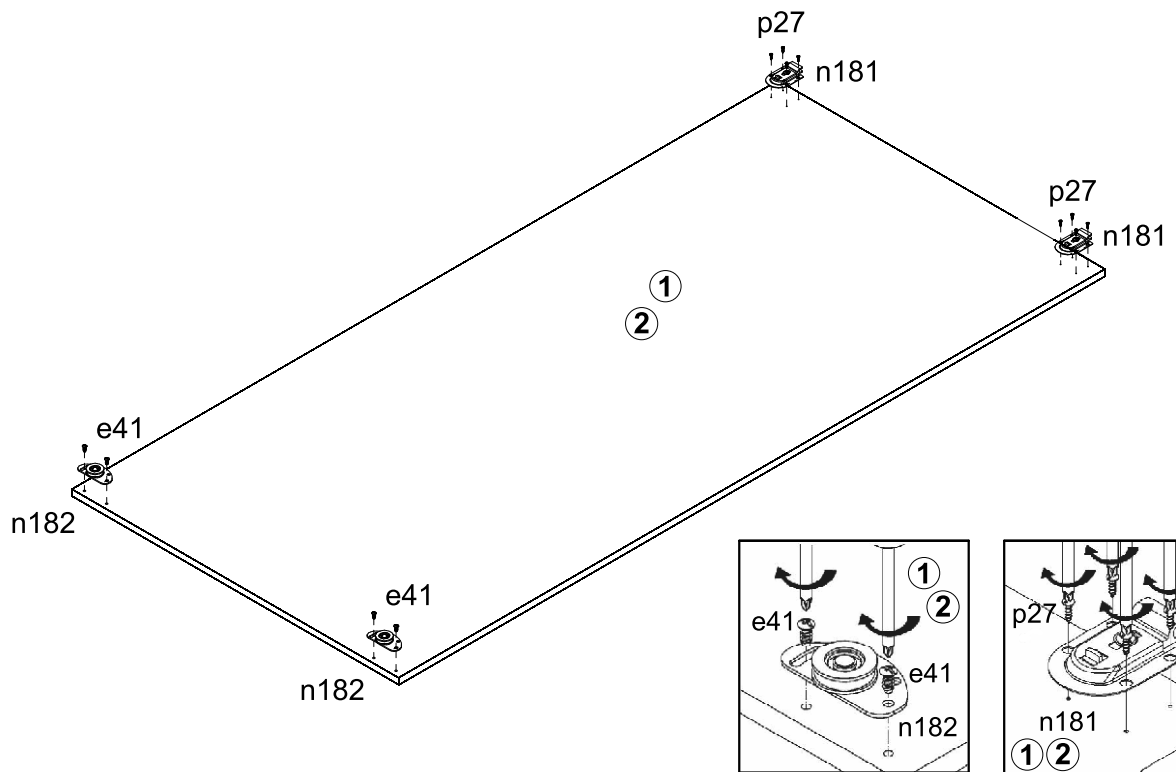

4

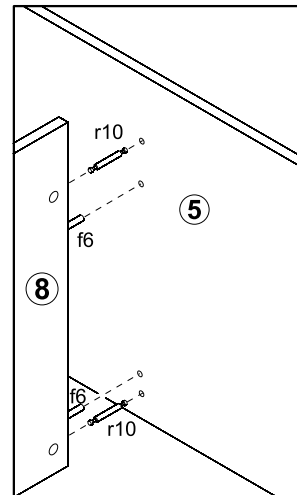
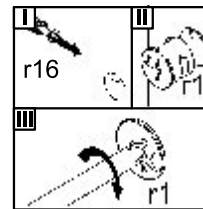
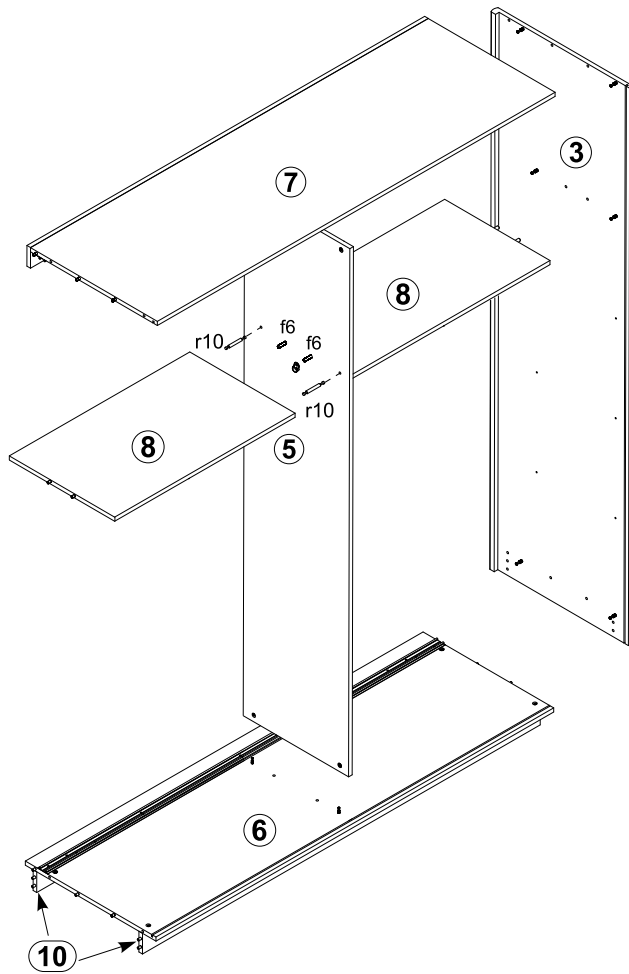
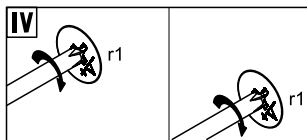
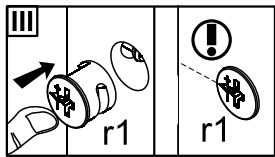
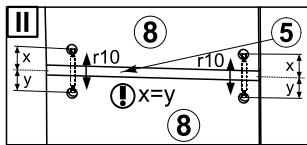
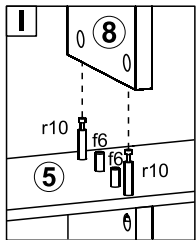

5

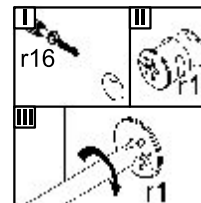
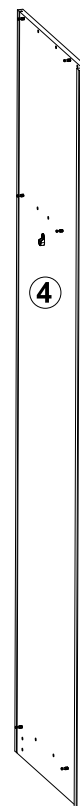
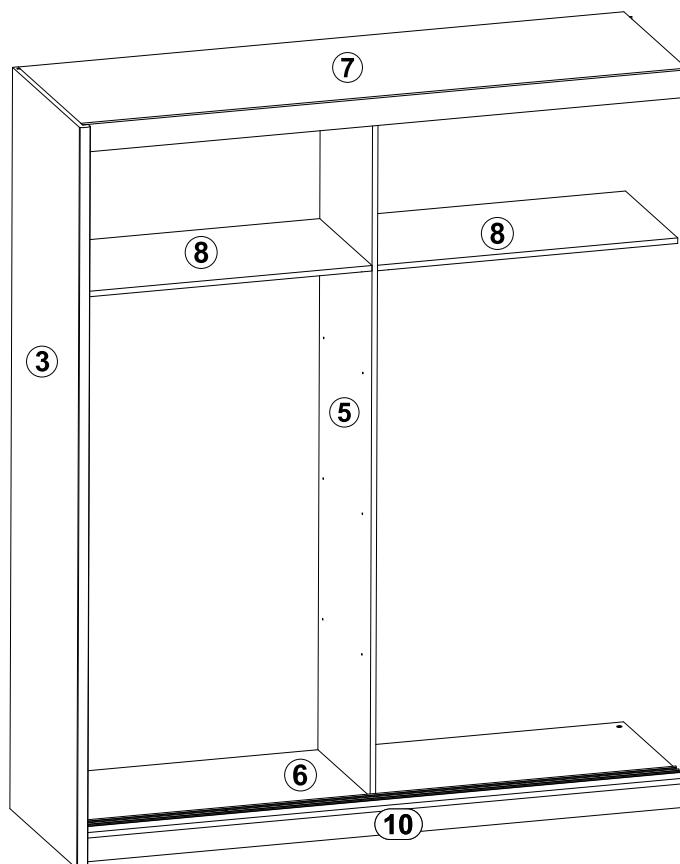

6

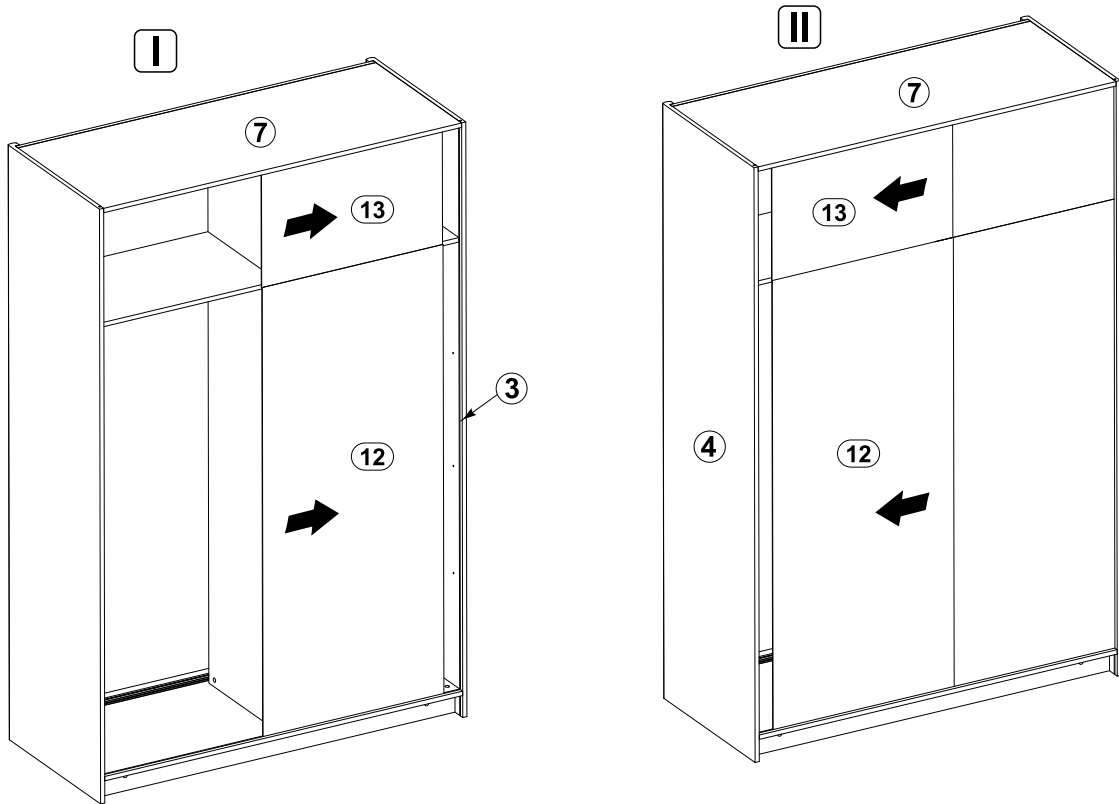

7

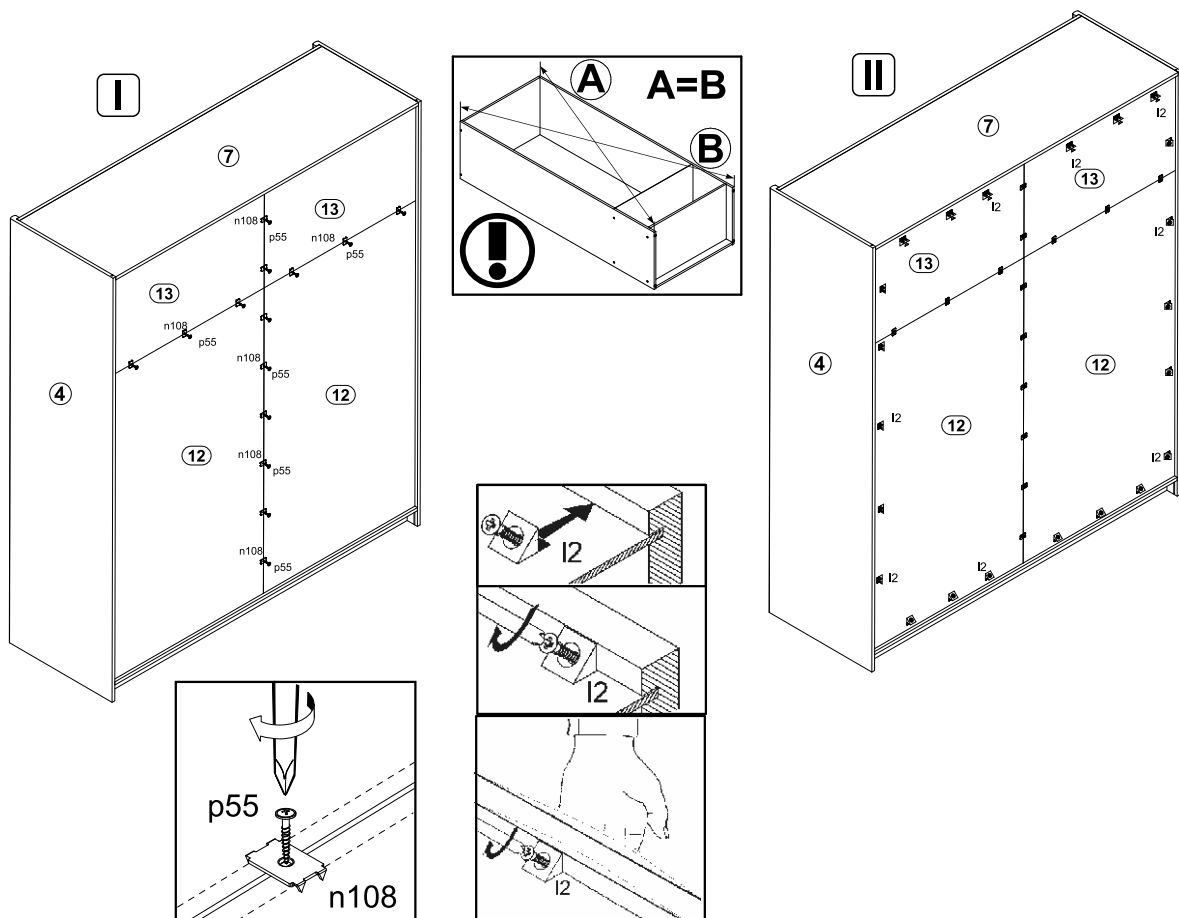

8

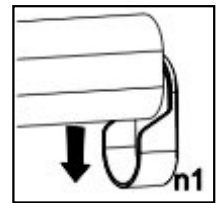
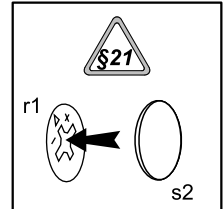
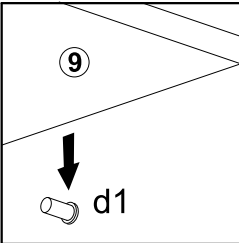
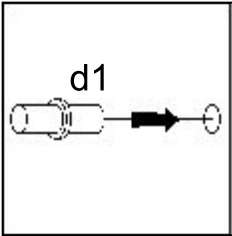
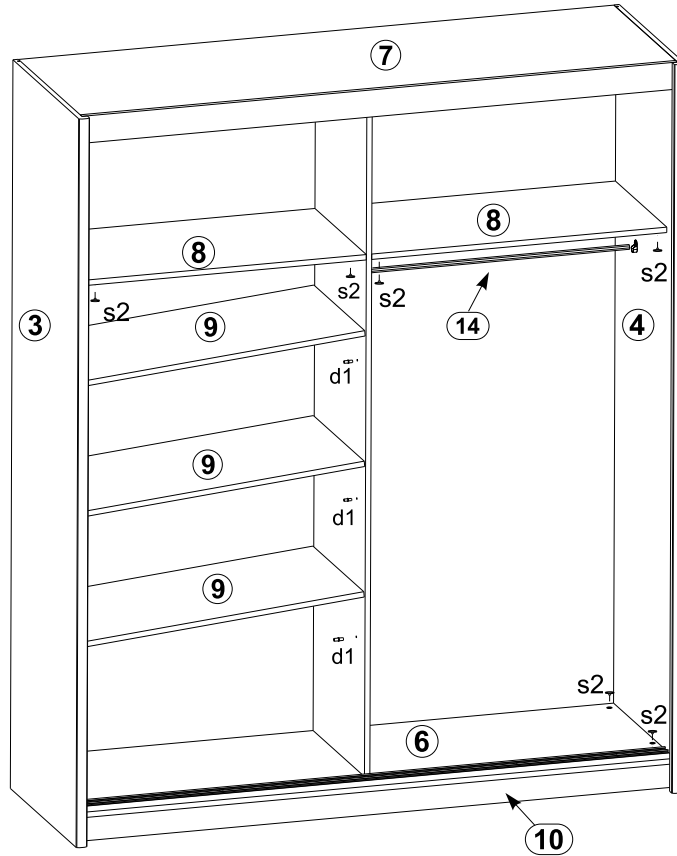

9

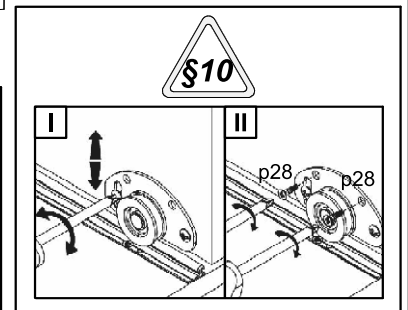
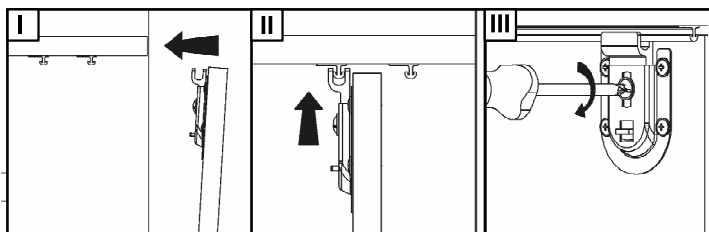
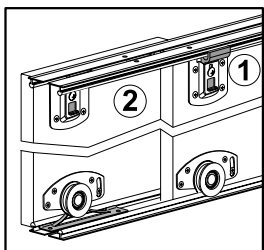
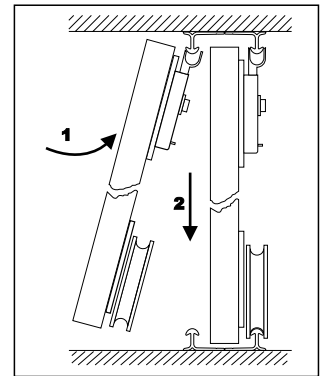
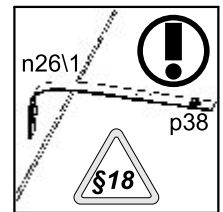
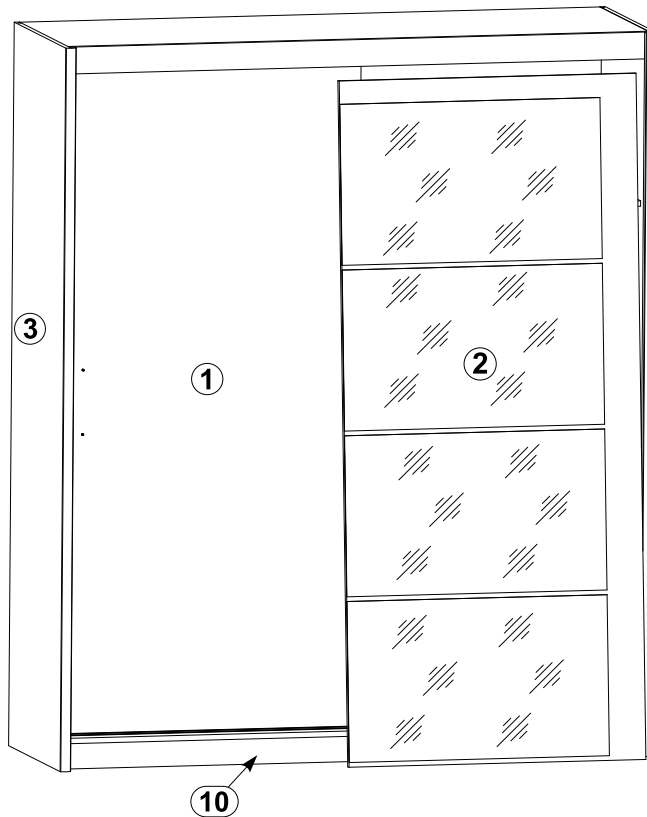

10

